

PREPARING FOR INSTALLATION

IMPORTANT INFORMATION

To prepare for the installation of your Manhattan Collection doors, read these instructions.

- Doors suited to internal applications only.
- Minimalist timber stiles and rails require precise machining to avoid glass breakage.

These instructions should be read in conjunction with any applicable product installation instructions and the Door Care and Maintenance Guide.

FACTORY PRE-MACHINING RECOMMENDED

- To avoid glass breakage, it is recommended that Corinthian Doors factory pre-machine doors for all hardware requirements.
- Doors feature a narrow 60mm door stile, meaning most conventional door hardware will **NOT** be compatible.
- **AVOID** modifications to pre-machined cut-outs (for example, deepening any cut-outs), as this could result in glass breakage.
- The Attica range of hardware (Mortice inserts, door handles and accessories), has been specially curated for use with doors that feature a 60mm or wider door stile.

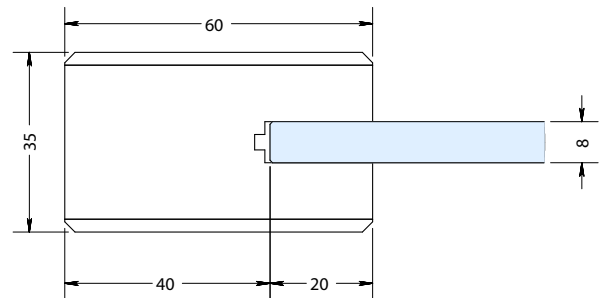

TRIMMING DOORS

- Maximum trim allowance is 3mm from top, bottom rails and each stile.
- **DO NOT** trim the lock stile of factory pre-machined doors. Any trimming will interfere with the installation of Mortice insert and door furniture.
- The glass extends 20mm into the timber door stile and rail, leaving a 40mm wide timber section for hardware installation.
- If trimming is required, carefully consider the glass location within the door stile and rails to avoid glass breakage.

HAND MACHINING FOR HARDWARE

- The glass infill is designed with a cut out to accommodate the required pocket depth for Mortice inserts – this is referred to as the 'Hardware Zone'.
- If machining the door for hardware by hand, it is important to identify the 'Hardware Zone' to avoid the risk of glass breakage and door damage.
- Regardless of the door height, the 'Hardware Zone':
 - Measures 230mm high x 50mm wide.
 - Located 875mm from the bottom of door and finishes 1105mm from bottom of door on both sides of the stile.

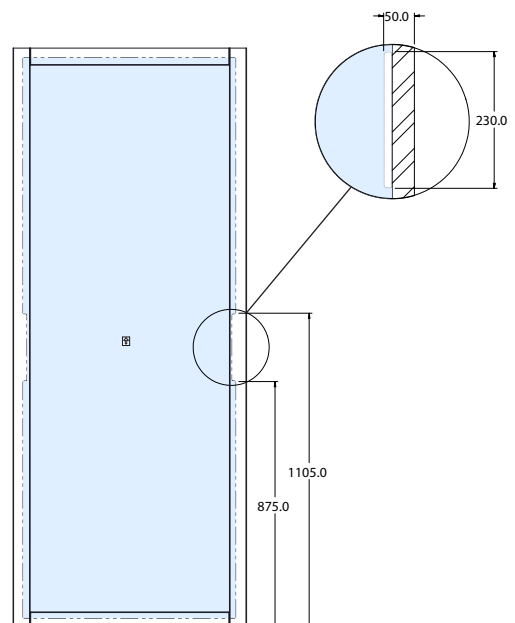

PREPARING FOR INSTALLATION

RECOMMENDED NUMBER OF HINGES FOR DOOR WEIGHT

- Follow the below guideline when hinging your doors.
- Door weights are indicative and do not include any hardware added to the door.

| DOOR HEIGHT (MM) | DOOR WIDTH (MM) | WEIGHT (KG) | RADIUS BUTT HINGE (QTY) | ATTICA CONCEALED HINGE (QTY) |
|------------------|-----------------|-------------|-------------------------|------------------------------|
| 2040 | 520 | 22 | 3 | 3 |
| | 620 | 26 | 3 | 3 |
| | 720 | 30 | 3 | 3 |
| | 820 | 34 | 3 | 3 |
| | 870 | 37 | 3 | 3 |
| | 920 | 39 | 3 | 3 |
| 2340 | 520 | 23 | 3 | 3 |
| | 620 | 31 | 3 | 3 |
| | 720 | 35 | 3 | 3 |
| | 820 | 40 | 3 | 3 |
| | 870 | 43 | 3 | N/A |
| | 920 | 45 | 3 | N/A |

MAXIMUM SCREW LENGTH

- Maximum screw length 30mm for all hardware fitment.
- **ALWAYS** predrill screw holes.
- Use a drill bit with the same diameter as the centre of the screw thread.

PRIMER AND PAINTING

- Doors are supplied as standard with a matt polyurethane based black primer.
- A light sand is recommended prior to the topcoat being applied.
- A minimum of 2 coats of paint **MUST** be applied if painting the doors an alternative colour.
- **ALWAYS** consult the paint manufacturer to determine the optimum products and number of coats required to achieve an alternative or light-coloured finish.
- Refer to the Door Care and Maintenance Guidelines for further information.

FAILURE TO ADHERE TO INSTALLATION INSTRUCTIONS WILL VOID WARRANTY.
For full Terms and Condition of Warranty visit www.corinthian.com.au/about/warranty

Whilst the utmost care is taken to ensure the accuracy of the information contained herein, it is provided in the understanding that the company shall under no circumstances be liable for any injuries, expenses or other losses which may in any way be attributable to the use or adoption of such data and/or design details. All dimensions indicated are nominal only. Corinthian Doors reserves the right to alter or amend without prior notice data and design details specified herein. Photographs or illustrations may not exactly depict the design or specification and may vary to actual. Doors and products are supplied unfinished unless otherwise specified. www.corinthian.com.au CORCNAT0634/224.